

The Alton

2 Bedroom Semi-Detached House



This exclusive development offers a stylish range of 2, 3, 4 and 5 bedroom traditional homes, perfect for first time buyers and families.

It is located within easy reach of historic uphill Lincoln and the bypass and benefits from excellent amenities, schooling and public transport.

Homes of **Quality** and **Style**

The Alton - a two bedroom semi-detached home

This modern home makes perfect use of the space on offer. On the ground floor, the quality kitchen features a dining area with french doors leading to the rear garden and the open plan staircase leads from the lounge. Upstairs there are two double bedrooms with fitted wardrobes to the master bedroom and a family bathroom.

The Alton features:

- Entrance Hall
- Lounge
- Kitchen/Dining
- Downstairs WC
- 2 Bedrooms
- Bathroom
- Garage
- Fully Fitted Kitchen
- Integrated Hob, Oven and Extractor
- Integrated Fridge/Freezer
- Integrated Dishwasher
- Fully Tiled Bathroom
- Fire
- Built in Wardrobes to Master Bedroom
- Shower and Shower Screen
- Alarm
- Turf to Front Garden

Sales Office: 01522 526 025 Head Office: 01522 512 200
www.taylorlindseyhomes.co.uk



The Alton 2 Bedroom Semi-Detached House



Ground Floor

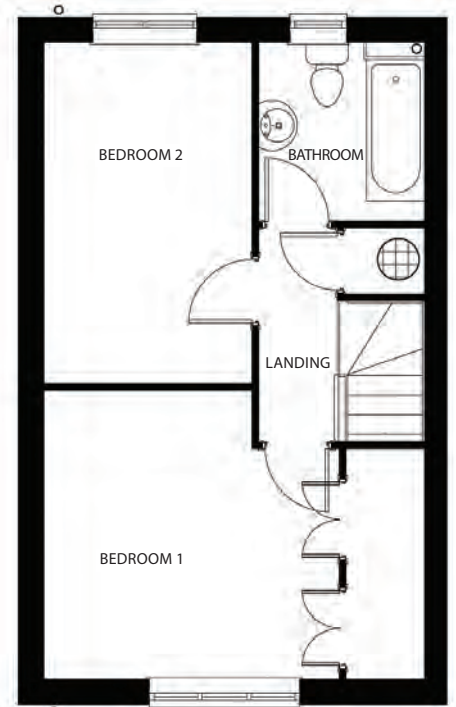

First Floor

GROUND FLOOR DIMENSIONS

Lounge	5.03m x 3.55m	16' 6" x 11' 8"
Kitchen/Dining	4.53m x 2.47m	14' 10" x 8' 3"

FIRST FLOOR DIMENSIONS

Bedroom 1	3.52m x 3.44m	11' 7" x 11' 4"
Bedroom 2	4.07m x 2.47m	13' 4" x 8' 1"
Bathroom	2.10m x 1.97m	6' 11" x 6' 6"

- 2 Bedroom Semi-Detached
- Entrance Hall
- Downstairs WC
- Lounge
- Kitchen/Dining
- Bathroom
- Garage

Illustrations are for indicative purposes only. Changes may be made without prior notice. All dimensions shown on this brochure are approximate and intended for guidance only.

Homes of **Quality** and **Style**

Sales Office: 01522 526 025 Head Office: 01522 512 200
www.taylorlindseyhomes.co.uk

